



Online Manual

You can find the Roku TV user guide and more details on setting up the TV by scanning the QR code below or by following the link:
<https://go.roku.com/tvmanual>



Technical Specification

	H24AR5G	F40AR5G
Energy Efficiency Class (SDR)	E	E
Power consumption (SDR)	17 W	35 W
Energy Efficiency Class (HDR)	G	G
Power consumption (HDR)	24 W	53 W
Screen resolution (pixels)	1366 x 768	1920 x 1080
Screen Size (diagonal)	60 cm / 24 inches	101 cm / 40 inches
RF	75 ohm Antenna / DVB / Satellite	
Inputs	3 x HDMI • 1 x USB • 1 x RJ45 LAN/Ethernet • 1x CVBS/Video + Audio input	
Sound Outputs	1 x Digital Optical Audio output • 1 x 3.5mm Headphone	
Speaker/Amplifier Watts (RMS)	2 x 5 / 2 x 3 W	2 x 8 / 2 x 8 W
Input voltage	AC 220 - 240V; ~50/60Hz	
Rated power consumption	50 W	70 W
Standby power consumption	<0.5 W	
Dimensions including stand (mm)	572 W x 362 H x 183 D	892 W x 571 H x 220 D
Net weight (Kgs)	2.7	5.3
Wall Mounting	VESA 100 x 100 (mm)	VESA 200 x 100 (mm)

HDMI

The terms HDMI, HDMI High-Definition Multimedia Interface, HDMI trade dress and the HDMI Logos are trademarks or registered trademarks of HDMI Licensing Administrator, Inc.

Dolby Audio

Manufactured under license from Dolby Laboratories. Dolby, Dolby Audio, and the double-D symbol are trademarks of Dolby Laboratories Licensing Corporation.

Roku TV

Roku, Roku TV, the Roku logo and the purple d-pad design are the trademarks or registered trademarks of Roku, Inc. in the United States and other countries. All other trademarks and logos herein are the property of their respective owners.

Roku® mobile app

To control your Roku device with the Roku mobile app, you must connect your mobile device to the same wireless network as your Roku device.

The Roku App (Official) on the App Store ([apple.com](https://apple.com/roku))



The Roku App (Official) - Apps on Google Play



VITADO • Roku TV

Quick Start Set Up Guide

For information on using the TV's features, please refer to the Operating Instructions. (Available online to download.)

Model Numbers

H24AR5G
F40AR5G

Quick & easy guide for setting up your VITADO Roku TV

What is included in the box

Using the remote control

Setting up the TV for the first time - including attaching the stand

Connecting other devices to the Television

Need help setting up or using your TV?

Please contact the UK & ROI Helpline*

Telephone UK / ROI 0330 024 0801

Online support at: vitado.tv

Email support at: service@umc-uk.co.uk

*Calls to 0330 numbers are charged at standard call rates and are included as part of any bundled minutes with your phone provider. Hours are correct at time of this document being published.
Please note these hours are subject to change periodically.
Calls to the ROI number are charged at the local call rate.

The helpline telephone opening hours are:

Monday - Friday: 8.30am – 6pm

For Saturdays and Bank Holidays, please refer to the website for our opening hours.



- STANDBY** – Turns TV on and off.
- NOTE:** TV will be in active standby for about 15 minutes after a Standby button press to turn off the TV. The TV will enter passive standby after this time. On a Standby button press to turn on the TV, the TV will resume instantly if in active standby or will take a few seconds longer if in passive standby.
- APPS KEYS** – Accesses specific applications quickly and directly.
- BACK** – Dedicated buttons vary by model and region.
- HOME** – Immediately returns to the Home screen.
- VOLUME UP / DOWN** – Increases and decreases the volume.
- NAVIGATION KEYS** – Navigating the TV menus and options:
 - **LEFT/RIGHT/UP/DOWN** moves the highlight in the corresponding direction.
 - **OK** selects the highlighted option.
- CHANNEL UP / DOWN** – Changes to the next or previous channel in the channel list. Scrolls through lists one page at a time.
- REPLAY** – Returns to the previously viewed TV channel.
- MUTE** – Mutes and unmutes TV sound.
- STAR** – Displays additional options when available. On-screen hints let you know when this button is active.
- REWIND** – Plays in fast rewind mode.
- PLAY / PAUSE** – Plays/pauses media.
- FAST FWD** – Plays in fast forward mode.
- COLOUR KEYS** – Function depends on interactive TV app being used.
- NUMBER KEYS** – Live TV: Direct channel entry. On-screen number pad: Direct number entry.
- TV** – Jumps directly to Live TV. Exits an interactive TV app.
- GUIDE** – Displays the programme guide.

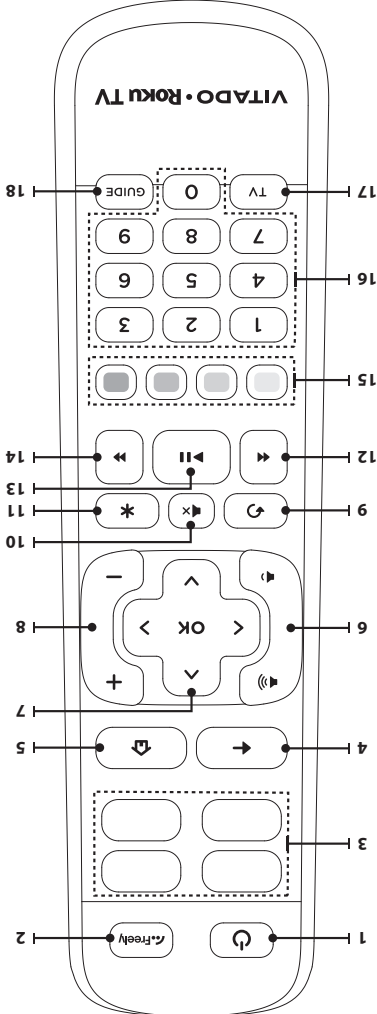

Using the remote control

What is included in the box

Accessories included with this TV are the following accessories

- 1 x Quick Start Guide
- 1 x Remote Control and 2 x AAA Batteries
- 1 x Safety Leaflet
- 1 x Stand Installation Pack



RF Cable

If you don't have the RF cable shown below, then you can purchase one from www.umc-uk.co.uk/cables If you want to add even more Freely channels, you'll need this cable to connect your TV to an RF socket.

Additional Accessories

This product contains technology subject to certain intellectual property rights of Microsoft. Use or distribution of this technology outside of this product is prohibited without the appropriate license(s) from Microsoft. Content owners use Microsoft PlayReady™ content access technology to protect their intellectual property, including copyrighted content. This device uses PlayReady technology to access PlayReady-protected content and/or WMDRM-protected content. If the device fails to properly enforce restrictions on content usage, content owners may require Microsoft to revoke the device's ability to consume PlayReady-protected content. Revocation should not affect unprotected content or content protected by other content access technologies. Content owners may require you to upgrade PlayReady to access their content. If you decline an upgrade, you will not be able to access content that requires the upgrade.

Please save your box/packaging as you will need this in the event of warranty/service repair or support. We are unable to carry out warranty/service if you are unable to package it correctly. The safest way to package your item in the event of warranty/service repair is in its original box/packaging.

Setting up your VITADO Roku TV for the first time

1 Fitting the Stand

The TV panel must be facing downwards.

For the stand installation, there is one type of screw provided as shown below.

Note: To complete the stand installation you will require a cross head screw driver.

4 x

Used for attaching the stand to the TV set (fig.2)

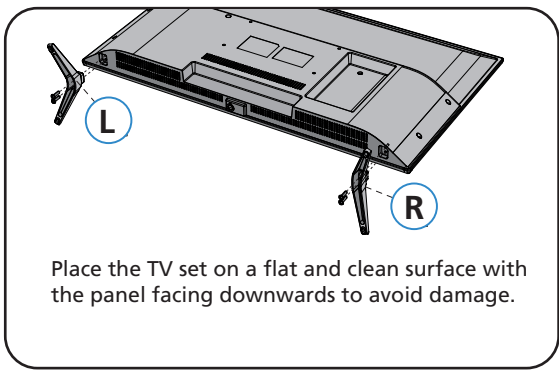

Place the TV set on a flat and clean surface with the panel facing downwards to avoid damage.

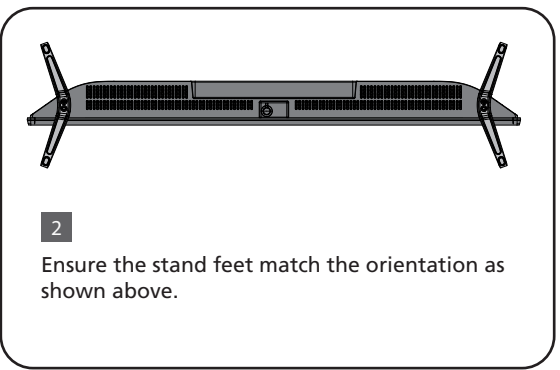

Ensure the stand feet match the orientation as shown above.

Wall Mounting the TV

Install the wall mounting bracket to the television as advised by the bracket manufacturer.

For the dimensions of the VESA mounting, please refer to the Technical Specifications section of this document.

TV Control Button

The TV is equipped with a single control button located at the bottom of the LED light.

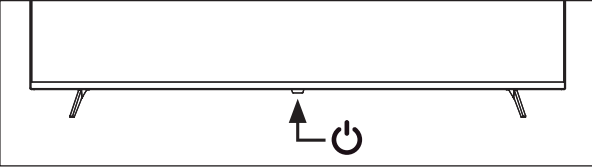

In standby mode.

Short press TV control button to turn on the TV.

In working status.

Long press TV control button to turn the TV to standby mode.

Short press TV control button to open the Inputs menu.

Close: Exit the Input menu.

Turn off TV: Turn the TV to standby mode.

Blu-ray Player: Access the external device connected through HDMI or AV terminal.

Live TV: Access the Live TV mode.

Home: Access the Home screen.

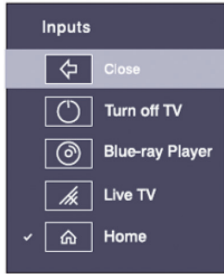

2 Connecting your Set

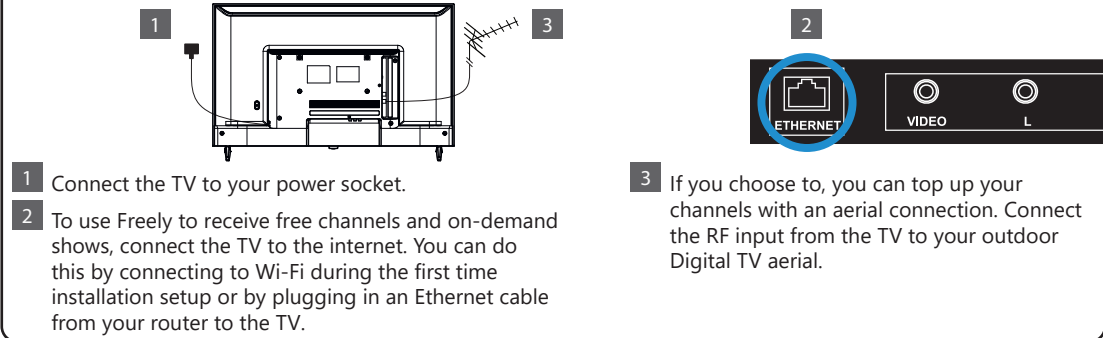

1 Connect the TV to your power socket.

2 To use Freely to receive free channels and on-demand shows, connect the TV to the internet. You can do this by connecting to Wi-Fi during the first time installation setup or by plugging in an Ethernet cable from your router to the TV.

3 If you choose to, you can top up your channels with an aerial connection. Connect the RF input from the TV to your outdoor Digital TV aerial.

3 Powering On the TV

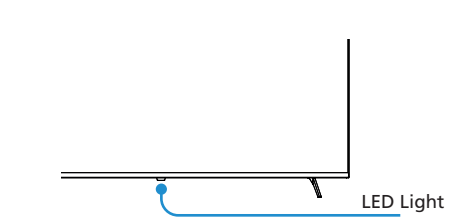

Switch on the television by pressing the on/off button on the bottom of the LED light.

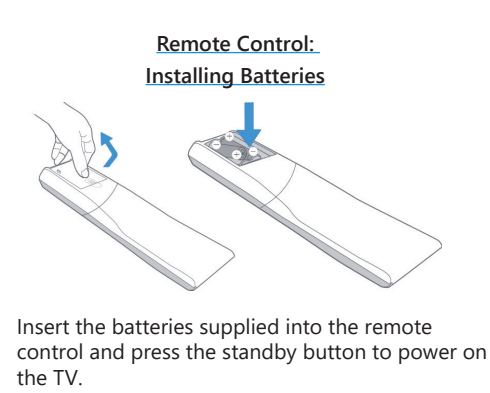

Remote Control:
Installing Batteries

Insert the batteries supplied into the remote control and press the standby button to power on the TV.

4 Set up your Roku TV

1. Introduction & Language

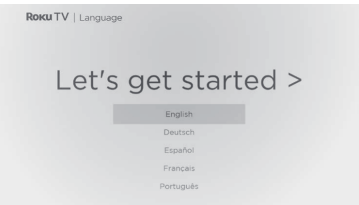

When the set first turns on, it enters the First Time Installation mode. The First Time Installation normally runs only once, the first time you turn on your TV. If you need to run it again, you must perform a factory reset by navigating to **Settings > System > Advanced system settings > Factory reset**, and then highlighting **Factory reset everything**. Select your preferred on-screen display language. This will change the language in which the menus and associated information is displayed in.

2. Country Selection

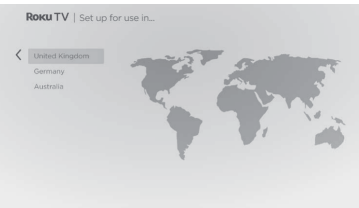

If you see this screen, select your country, and then press OK.

3. TV Mode



Press OK to select **Set up for home use**. This is the right choice for enjoying your TV at home. It provides energy saving options as well as access to all features of the TV.

Note: **Set up for shop use** configures the TV for retail display and is not recommended for any other use.

4. Network Setup

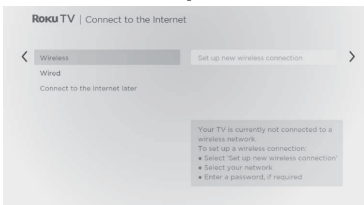

You can connect the TV to your broadband router or wireless network in order to take advantage of the Smart functions. If you connect the TV to your router using an Ethernet cable, the Wi-Fi set up will be skipped.

5. Wireless Network Setup

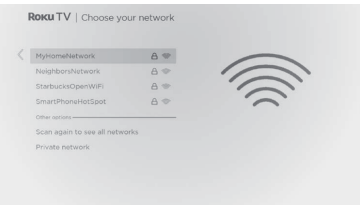

If you selected option **Wireless** in previous step, the TV scans for the wireless networks within range and displays them. Select your network by using up/down arrows and confirm with OK.

6. Entering Wi-Fi password

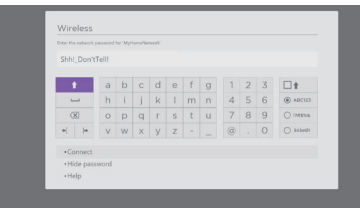

If your wireless network is password protected, an on-screen keyboard appears. Enter your wireless network password by using the purple directional pad. When you finish, press the down arrow to select **Connect**, and then press OK.

7. Activation

After the TV restarts, it prompts you through activation. Use a computer, tablet or mobile phone with an Internet connection to link to a new or existing Roku account.

You need a Roku account to activate your Roku TV and access entertainment across thousands of streaming channels.

Note: **Roku does not charge for activation support, beware of scams.** Roku accounts are free. Providing your credit card

information during signup makes renting, purchasing and subscribing to entertainment from the Roku Channel Store fast and convenient. If you aren't ready to connect your TV to a network, you can still use it as regular TV.

8. Connect your devices

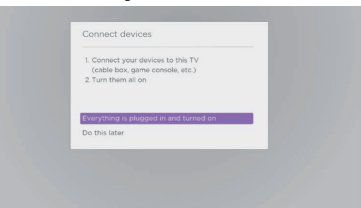

Connect all the devices you plan to use with your TV (such as Blu-ray™ player or game console), turn them all on, and then select **Everything is plugged in and turned on**. The TV now takes you step by step through each of its inputs and asks what kind of device you have connected.



Press arrow keys to highlight the label you want to associate with the input, and then press OK. If you are not using the input, select **Nothing**, and the input won't appear on the Home screen.

Connectivity

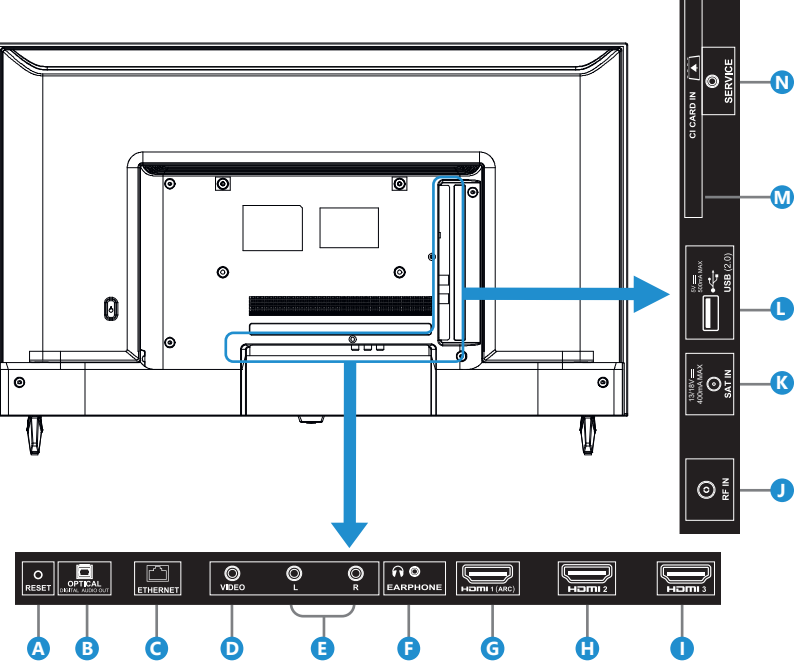

A	RESET	Factory reset button	I	HDMI 3	HDMI input
B	OPTICAL	Digital Audio Output	J	RF in	RF/TV Aerial input
C	ETHERNET	Network connection	K	SAT in	Satellite input
D	Video	Composite/CVBS Video	L	USB 2.0	USB Port
E	L/R	Audio for Composite/CVBS	M	CI card in	Slot for Conditional Access Module
F	Earphone	Earphones input	N	Service Input	Input is used only by service centres
G	HDMI 1 (ARC)	HDMI input with ARC			
H	HDMI 2	HDMI input			

Setting up the TV Tuner

1. Make sure that your aerial (not provided) is connected to the TV's RF IN input.
2. On the Home screen, select the **Live TV** input. If it is not on your Home screen, go to **Settings > TV Inputs** to add it.
3. Read the simple on-screen instructions, and then select **Start finding channels**.
4. If prompted, select your time zone. You'll only need to do this if the TV can't figure out your time zone from your Internet connection.

VITADO
Roku TV