



SHA/QSW/0256



# Technical Specification

24BI2KA 24BI3KA	
Energy Efficiency Class (SDR)	F
Power consumption (SDR)	21 W
Screen resolution (pixels)	1366 x 768
Screen Size (diagonal)	60 cm / 24 inches
RF	75 ohm Antenna / Analog / DVB / Satellite
Inputs	2 x HDMI • 2 x USB • 1 x Micro SD card reader • 1 x RJ45 LAN/Ethernet 1 x Composite/CVBS Video • 1 x Mini Component/YpPr • 1 x L/R Audio input for Composite/CVBS & Component/YpPr
Sound Outputs	1 x Digital Optical Audio output • 1 x 3.5mm Headphone
Speaker/ Amplifier Watts (RMS)	2 x 5 / 2 x 3
Voltage and power consumption	AC 220V ~ 240V; 50Hz 21/40W (ecomode/max) (<0.5W in Standby)
Dimensions including stand (mm)	560W x 385H x 140D
Net weight (Kgs)	3.8
Wall Mounting	VESA 100 x 100 (mm)



The terms HDMI, HDMI High-Definition Multimedia Interface, HDMI trade dress and the HDMI Logos are trademarks or registered trademarks of HDMI Licensing Administrator, Inc.



Google, Google Play, YouTube, Android TV and other marks are trademarks of Google LLC.



Manufactured under license from Dolby Laboratories. Dolby, Dolby Audio, and the double-D symbol are trademarks of Dolby Laboratories Licensing Corporation.

# SHARP

## androidtv

### Quick Start Set Up Guide

For information on using the TV's features, please refer to the Operating Instructions. (Available online to download.)

#### Model Numbers

24BI2KA

24BI3KA

Register your manufacturers guarantee online within 14 days of purchase at

[www.registertoday.co.uk/sharp](http://www.registertoday.co.uk/sharp) and enter into a prize draw to

### Win a SHARP Soundbar

Terms and conditions apply. Online registration only.



#### Quick & easy guide for setting up your TV

What is included in the box

Using the remote control

Setting up the TV for the first time - including attaching the stand

Connecting other devices to the Television

#### Need help setting up or using your TV?

Please contact the UK & ROI Helpline\*

Telephone UK 0330 024 0803 or ROI 01443 3323

Online support at: [www.umc-uk.co.uk](http://www.umc-uk.co.uk)

Email support at: [service@umc-uk.co.uk](mailto:service@umc-uk.co.uk)

\*Calls to 0330 numbers are charged at standard call rates and are included as part of any bundled minutes with your phone provider.

Calls to the ROI number are charged at the local call rate.

The telephone opening hours are:

Monday to Friday: 8.30am - 6pm

Saturday: 9am - 5pm

Bank Holidays: 10am - 4pm

Closed Christmas and New Years day.



SHA/QSW/0256

### Sky Remote Code

If you wish to use your Sky remote to operate the TV's basic functions, you will need a Sky remote control (Revision 9 or later) and you will need to program it with the code 2134. If you wish to use your Sky Q remote to operate the TV's basic functions, you will need to program it with the code 4170.



## What is included in the box

To launch the online manual, press the HOME button, select Apps from the Home menu, and select "E-Instruction Manual" from the apps list.

#### Accessories

- 1 x Quick Start Guide
- 1 x Remote Control and 2 x AAA Batteries
- 1 x Safety Leaflet
- 1 x Stand installation pack

Included with this TV are the following accessories

#### Additional Accessories

Should you wish to connect older/analogue devices to your television, you can purchase the necessary cables either from your retailer or at [www.umc-uk.co.uk/cables](http://www.umc-uk.co.uk/cables)

Mini! YpPr Cable

Required if you wish to connect a device with YpPr/Component output to the TV's Mini! YpPr Input



RF Cable

#### Microsoft PlayReady™

This product contains technology subject to certain intellectual property rights of Microsoft. Use or distribution of this technology outside of this product is prohibited without the appropriate license(s) from Microsoft.

Content owners use Microsoft PlayReady™ content access technology to protect their intellectual property, including copyrighted content. This device uses PlayReady technology to access PlayReady-protected content and/or WDRM-protected content. If the device fails to properly enforce restrictions on content usage, content owners may require Microsoft to revoke the device's ability to consume PlayReady-protected content. Revocation should not affect unprotected content or content protected by other content access technologies. Content owners may require you to upgrade PlayReady to access their content. If you decline an upgrade, you will not be able to access content that requires the upgrade.



Freeview Play brings together live TV viewing with "catch up" TV services such as BBC iPlayer, ITV player, More4 and Demand 5. The Freeview Play Explore app features a carousel of genres to select from when searching for programmes, such as sport, comedy, dramas and soaps, etc. Content is made up from recommendations of the major broadcasters and offers an alternative means of searching.

Note that to use the full functionality of Freeview Play your set must be connected to the internet.

Please save your box/packaging as you will need this in the event of warranty/service repair or support. We are unable to carry out warranty/service if you are unable to package it correctly. The safest way to package your item in the event of warranty/service repair is in its original box/packaging.

## Using the remote control

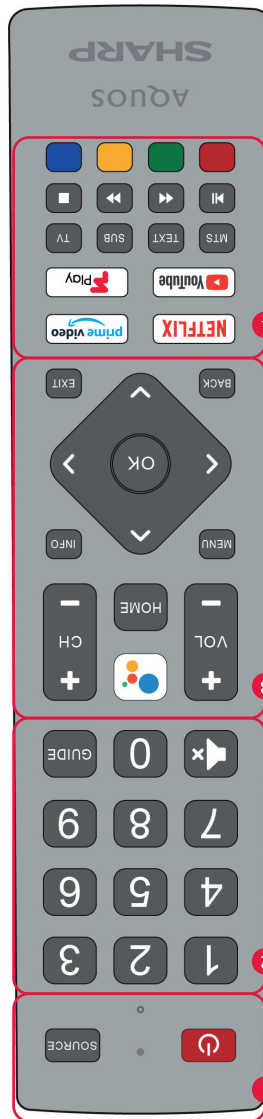

- 1** STANDBY - Switch on the TV when in standby or vice versa. By long pressing of this button, the set will display a menu offering power down option to energy saving standby mode.
- 2** NUMBER BUTTONS - 0-9 to select a TV channel directly.
- 3** MUTE - Mute the sound or vice versa.
- 4** GUIDE - Opens the 7 day TV guide (digital TV mode).
- 5** The Google Assistant - Use your voice to access entertainment, control smart devices, obtain answers on screen, and more.
- 6** HOME - Display the TV Home Menu.
- 7** CH (+/-) - To increase or decrease the channel being watched.
- 8** MENU - Display LIVE TV menu. This button works only in sources (TV, HDMI, Component, etc.). It will not work in the Home Menu.
- 9** INFO - Press once for now/next channel information.
- 10** (+/-/OK) - Allows you to navigate the on-screen menus and adjust the system settings to your preference.
- 11** BACK - To go back a previous step.
- 12** EXIT - To exit all menus.
- 13** NETFLIX - Access the Netflix App.
- 14** Prime Video - Access the Prime Video App.
- 15** YouTube - Access the YouTube App.
- 16** Freeview Play - Access the Freeview Play app, service.
- 17** MTS - Opens audio track menu.
- 18** TEXT - To enter/exit teletext.
- 19** SUB - To switch the dialogue at the bottom of the screen (on/off).
- 20** TV - To switch to Live TV.
- 21** COLOUR BUTTONS - Execute corresponding function at that time
  - ▶ To play/pause media
  - ▶ To play in fast forward mode
  - ▶ To play in fast reverse mode
  - ▶ To stop the playback

# Setting up the TV set for the first time

To obtain a copy of your Operating Instructions, please go to: [https://www.umc-uk.co.uk/instruction-manuals/Sharp-Television\\_information.html](https://www.umc-uk.co.uk/instruction-manuals/Sharp-Television_information.html)

## 1 Fitting the stand

For stand installation, there are two types of screws provided as shown below. To complete the stand installation you will require a cross head screw driver. Place the TV set on a flat and clean surface with the panel facing downwards to avoid damage.



**3 x M (4x12)**  
Used for attaching the stand neck to the TV (fig.1)

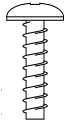

**4 x ST (4x12)**  
Used for attaching the stand base to the stand neck (fig.3)

- 1 Attach the stand neck to the rear of the TV set using the 3 x M(4x12) screw.

- 2 Peel off the protective plastic cover then attach the stand base to the stand neck.

- 3 Secure the base to the neck by using the 4 x ST(4x12) screws provided.

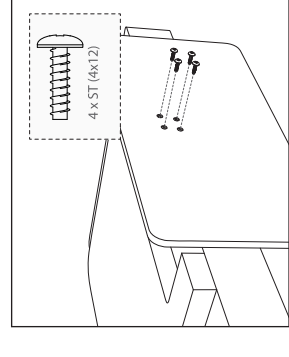

- 1 When securing the self-tapping screws into the base of the stand (on first installation) the screw/s will be naturally tight as they create a thread in the plastic of the stand neck in order to support a TV of this size.

- 2 Ensure the cross head screw driver tip fits correctly into the head of the screw and that it is not too big or small.

- 3 Screw in all screws individually and partially before tightening all of the screws fully.

- 4 If they become very tight try loosening them slightly and then re-tightening them once again as this will continue the process of creating the thread for the screws.

### HELPFUL ADVICE FOR FIRST TIME STAND INSTALLATION

## 2 Connecting your set

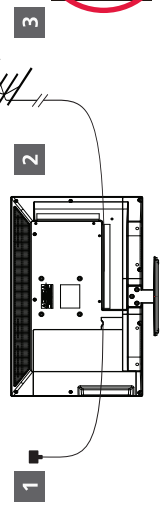

- 1 Connect the TV to your power socket.
- 2 If you wish to use the TV to receive Freeview/Saorview channels, connect the RF input from the TV to your outdoor Digital TV aerial. If you do not wish to receive Freeview/Saorview, skip this step.
- 3 Connect to the internet. Ethernet provides the most stable connection.

## 4 First time installation

Basic installation steps are shown below. These may vary slightly depending on your model. Due to Android software updates, the look and feel of the TV start up procedure and subsequent menus can be subject to change.

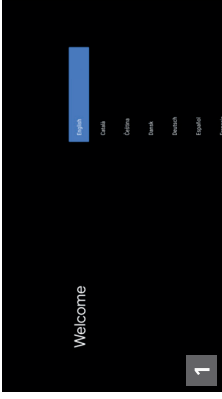

When the set first turns on, it will ask you to select your preferred on-screen display language. This will change the language in which the menus and associated information is displayed in.

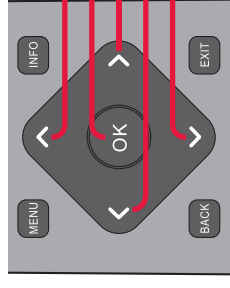

- Press to navigate up
- Press to confirm a selection
- Press to navigate right
- Press to navigate left
- Press to navigate down

## 3 Installing Batteries

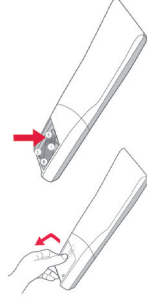

Insert the batteries supplied into the remote control and press the standby button to power on the TV.

## Button layout

- 1 Stop/Eject DVD\*
- 2 Play/Pause DVD\*
- 3 Volume up and menu right
- 4 Volume down and menu left
- 5 Programme/Channel up and menu up
- 6 Programme/Channel down and menu down
- 7 Displays Menu/OSD
- 8 Displays the input source menu
- 9 Standby Power On/Off

\*For models with built-in DVD player

## 5 Pairing the remote

If during the first time installation process the remote was not paired or skipped, then follow the process below to pair your remote with the television.

- 1 Turn the set on.
- 2 Press the **HOME** button on the remote control.
- 3 The pairing screen will appear on the TV.
- 4 Now press and hold the "Left" and "Home" buttons on the remote simultaneously (highlighted).



- 5 The LED indicator on the remote control will start to flash.

- 6 Select the detected remote control shown on the screen and press OK.

- 7 Once paired the pairing screen will disappear.

This process will only need to be carried out if the remote is not paired. Once paired, when the **HOME** button is pressed it will open the Google Assistant screen on the set and activate voice functionality.

## 6 The Google Assistant

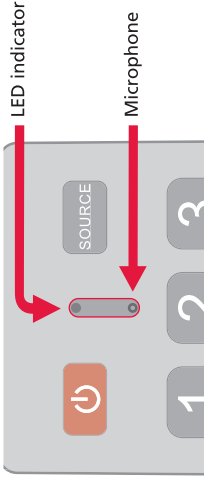

### Using the Google Assistant with your voice

Remote controls with the Google Assistant have a Google Assistant dedicated button and a built-in microphone. To use this feature with the Google Assistant remote control, follow the instructions as below.

- 1 Before using the Google Assistant, you will need to pair the remote. Please follow step 5 of this guide to pair your remote to enable the Google Assistant.
- 2 Press the **HOME** button. The LED indicator on the remote control will illuminate.
- 3 Wait for the on-screen message from the Google Assistant, then speak into the microphone. A good rule of thumb is to have the microphone positioned about 15-30 centimetres away from your mouth.

By speaking into the microphone, you can search for various content or control your connected smart home devices. Speech examples may be displayed on the television screen depending on your model.

## Win a SHARP Soundbar

Register your manufacturer's guarantee online within 14 days of purchase at [www.registertoday.co.uk/sharp](http://www.registertoday.co.uk/sharp) and enter into a prize draw to win a Sharp Soundbar

Terms and conditions apply. Online registration only.



## Wall Mounting the TV

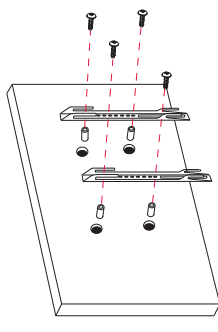

- 1 Remove the four screws that are supplied in the wall mounting holes.
- 2 The wall mount can now be easily attached to the mounting holes on the rear of the TV.
- 3 Install the wall mounting bracket to the television as advised by the bracket manufacturer.

Image for illustration only.

For the dimensions of the VESA mounting, please refer to the Technical Specifications section of this document.

The picture shows the use of spacers, which are not applicable to all sets/installations.

## Connectivity

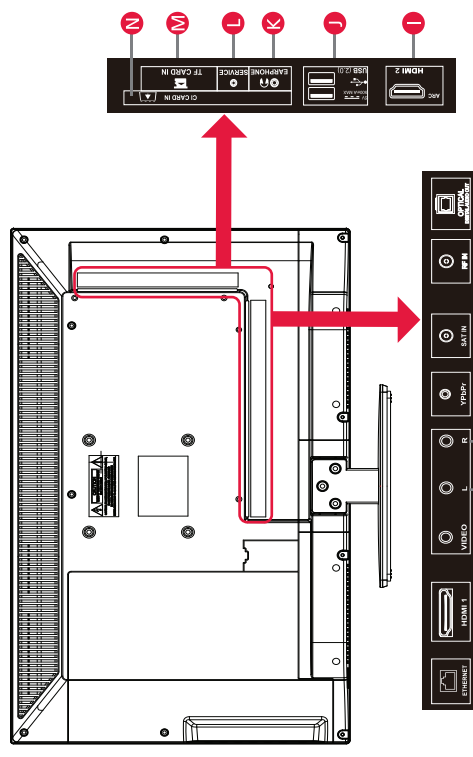

<b>A</b> ETHERNET	Network connection	<b>I</b> HDMI 2 (ARC)	HDMI Input
<b>B</b> HDMI 1	HDMI Input	<b>J</b> 2 x USB	USB Port
<b>C</b> VIDEO	Composite/CVBS Video	<b>K</b> Earphone	Earphone Input
<b>D</b> L-R Audio	Audio shared for Video/Composite and component/YBPPr	<b>L</b> Service Input	Input is used only by service centres
<b>E</b> YBPPr	YBPPr-video input	<b>M</b> SD	SD card input
<b>F</b> SAT IN	Satellite Input	<b>N</b> CI card in	Slot for Conditional Access Module (CAM)
<b>G</b> RF IN	RF IN		
<b>H</b> Optical Digital Audio	Digital Audio Output		