

Technical Specification

Product fiche

Trademark	Sharp
Model ID	24BC0K 24BE0K 24BE0KW
Energy efficiency class	A
Visible screen size (diagonal)	60 cm / 23.6 inches
On-mode power consumption	25.0 W
Annual energy consumption *1	37 kWh
Standby power consumption *2	<0.50 W
Off mode power consumption	n/a
Screen resolution	1366 (H) x 768 (V)
*1: Energy consumption XYZ kWh per year, based on the power consumption of the television operating 4 hours per day for 365 days. The actual energy consumption will depend on how the television is used. *2: When the TV is turned off with the remote control/standby button and no function is active.	

	24BC0K	24BE0K 24BE0KW
RF	75 ohm Antenna / Analog / DVB	
Inputs	2 x HDMI, 2 x USB, 1 x SCART, 1 x Mini Component/YPbPr, 1 x Mini AV IN - Composite Video/CVBS and L/R Audio shared for Composite Video and Component/YPbPr, 1 x RJ45 LAN/Ethernet	
Sound Outputs	1 x Digital Optical Audio output, 1 x 3.5mm Headphone	
Speaker / Amplifier Watts (RMS)	2 x 5 / 2 x 3	
Voltage and power consumption	AC 220V ~ 240V; 50Hz 25/40W (ecomode/max) (<0.5W in Standby)	AC 220V ~ 240V; 50Hz 25/50W (ecomode/max) (<0.5W in Standby)
Dimensions including stand (mm)	560W x 386H x 140D	
Net weight (Kgs)	3.8	4.2
Wall Mounting	VESA 100 x 100 (mm)	

HDMI

The terms HDMI, HDMI High-Definition Multimedia Interface, and the HDMI Logo are trademarks or registered trademarks of HDMI Licensing Administrator, Inc.



Quick Start Set Up Guide

For information on using the TV's features, please refer to the operating Instructions.

Model Numbers

24BC0K

24BE0K

24BE0KW

Register your manufacturers guarantee online within 14 days of purchase at www.registertoday.co.uk/sharp and enter into a prize draw to

Win a
SHARP
Soundbar

Terms and conditions apply. Online registration only.

Quick & easy guide for setting up your TV

What is included in the box

Using the remote control

Setting up the TV for the first time - including attaching the stand

Connecting other devices to the Television

Need help setting up or using your TV?

Please contact the UK & ROI Helpline*

Telephone UK 0330 024 0803 or ROI 01443 3323

Online support at: www.umc-uk.co.uk

Email support at: service@umc-uk.co.uk

*Calls to 0330 numbers are charged at standard call rates and are included as part of any bundled minutes with your phone provider.

Calls to the ROI number are charged at the local call rate.

The telephone opening hours are Monday to Friday 8.30am to 6pm, Saturday 9am – 5pm.

Bank Holidays - 10am to 4pm

Closed Christmas and New Years day



If you wish to use your Sky remote to operate the TV's basic functions, you will need a Sky remote control (Revision 9 or later) and you will need to program it with the code 2134. If you wish to use your Sky Q remote to operate the TV's basic functions, you will need to program it with the code 4170.



Sky Remote Code

- INFO** - Press once for now/next channel information.
- Press twice for information about the current programme.
- SUBTITLE** - To switch the dialogue at the bottom of the screen (on/off).
- TEXT** - To enter/exist Text.
- TV** - To switch to Digital Channels.
- YOUTUBE** - Access the Youtube App.
- NETFLIX** - Access the Netflix App.
- APPS** - Access the APPS menu.
- RECORD** - Access the USB record function.
- REC LIST** - Opens the list of previously recorded items.
- REPEAT** - To repeat the current chapter.
- GOTO** - To go to a specific chapter.
- A-B** - Press once to set point, press a second time to return to point.
- ANGLE** - Select different angle of DVD.
- REPEAT** - To repeat playback.

- VOL (+/-)** - To increase/decrease the sound level.
- PICTURE** - Scrolls through picture mode options.
- SOUND** - Scrolls through sound mode options.
- SOURCE** - To display the input/source menu.
- CH (+/-)** - To increase or decrease the channel being watched.
- EXIT** - To exit all menus.
- MENU** - To display OSD menu.
- BACK** - To go back a previous step.
- FAV** - To display favourites menu.

- NUMBER BUTTONS** - 0-9 to select a TV channel directly.
- MUTE** - Mute the sound or vice versa.
- TV GUIDE** - Opens the 7 day TV guide (digital TV mode).

- STANDBY** - Switch on the TV when in standby or vice versa.
- FREEVIEW PLAY** - Access the Freeview Play app.

- For models with integrated DVD players.
- For models with PVR Function.
- For models with USB Playback.
- For models with 3D functions.

Key

Using the remote control



Additional Accessories

Should you wish to connect older/analogue devices to your television, you can purchase the necessary cables either from your retailer or at www.umc-uk.co.uk/cables

- 1 x Quick Start Guide
- 1 x Stand installation pack (includes stand base, stand neck & screws)
- 1 x Safety Leaflet
- 1 x Remote Control & 2 x AAA Batteries

Included with this TV are the following accessories

What is included in the box

To launch the Online Manual, press the [MENU] button and then select Settings>About TV>Help Information>View Online Manual

Online Manual

Please save your box/packaging as you will need this in the event of warranty/service repair or support. We are unable to carry out warranty/service if you are unable to package it correctly. The safest way to package your item in the event of warranty/service repair is in it's original box/packaging.

Freeview Play brings together live TV viewing with "catch up" TV services such as BBC iPlayer, ITV player, More4 and Demand 5. The Freeview Play Explore app features a carousel of genres to select from when searching for programmes, such as sport, comedy, dramas and soaps, etc. Content is made up from recommendations of the major broadcasters and offers an alternative means of searching.

Note that to use the full functionality of Freeview Play your set must be connected to the internet.

To receive Freeview channels, in particular Freeview HD channels, you will need a Digital TV aerial and be in a good Freeview coverage area. You can check coverage for your postcode at www.freeview.co.uk. Please note that any Freeview HD channels found during tuning will be placed in channel positions above 100. For example, 101 (BBC1 HD) 102 (BBC2 HD) etc.

Connecting Component/YpPr - you will need both the Mini YpPr Cable and the Mini Composite/AV Cable. The YpPr cable will be used exclusively for video (red/green/blue) and the AV cable will be used for audio (Red/White while Yellow stays unconnected).



Mini YpPr Cable
Required if you wish to connect a device with YpPr/Component output to the TV's Mini YpPr Input



Mini Composite/AV Cable
Required if you wish to connect a device with AV/Composite/CVBS output to the TV's Mini AV Input

RF Cable
Required if you wish to connect to terrestrial services





Setting up the TV set for the first time

To obtain a copy of your Operating Instructions, please go to: www.umc-uk.co.uk/instruction-manuals/sharp

1 Fitting the stand

For stand installation, there are two types of screws provided as shown below. To complete the stand installation you will require a cross head screw driver.

Place the TV set on a flat and clean surface with the panel facing downwards to avoid damage.

- **3 x M (4x12)**
Used for attaching the stand neck to the TV (fig.1)
- **4 x ST (4x12)**
Used for attaching the stand base to the stand neck (fig.3)

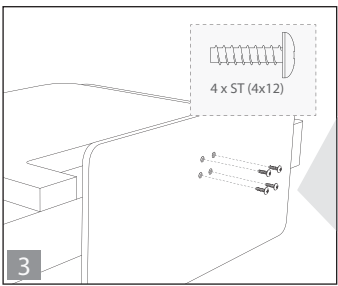
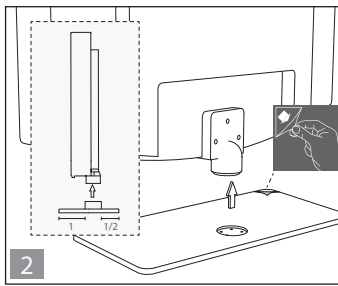
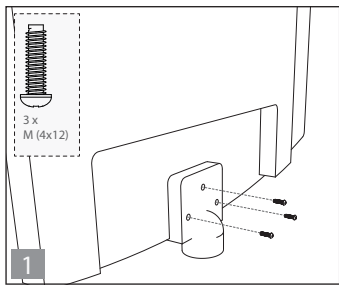

HELPFUL ADVICE FOR FIRST TIME STAND INSTALLATION

When securing the self-tapping screw/s into the base of the stand (on first installation) the screw/s will be naturally tight as they create a thread in the plastic of the stand neck in order to support a TV of this size.

- Ensure the cross head screw driver tip fits correctly into the head of the screw and that it is not too big or small.
- Screw in all screws individually and partially before tightening all of the screws fully.
- If they become very tight try loosening them slightly and then re-tightening them once again as this will continue the process of creating the thread for the screws.

1. **(fig.1)** Attach the stand neck to the rear of the TV set using the 3 x M(4x12) screw. **(fig.2)** Peel off the protective plastic cover then attach the stand base to the stand neck. **(fig.3)** Secure the base to the neck by using the 4 x ST(4x12) screws provided.

Win a

SHARP Soundbar

Register your manufacturers guarantee online within 14 days of purchase at www.registertoday.co.uk/sharp and enter into a prize draw to win a Sharp Soundbar

Terms and conditions apply. Online registration only.



2 Connecting your set

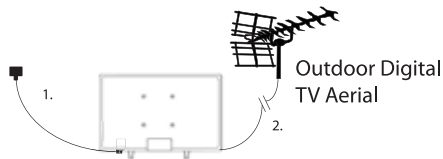

- Connect the TV to your power socket.
- If you wish to use the TV to receive Freeview/Saorview channels, connect the RF input from the TV to your outdoor Digital TV aerial. If you do not wish to receive Freeview/Saorview, skip this step.

3 Installing Batteries



Insert the batteries supplied into the remote control and press the standby button to power on the TV.

Button layout

- Stop/Eject DVD*
- Play/Pause DVD*
- Volume up and menu right
- Volume down and menu left
- Programme/Channel up and menu up
- Programme/Channel down and menu down
- Displays Menu/OSD
- Displays the input source menu
- Standby Power On/Off



*For models with built in DVD player

Wall Mounting the TV

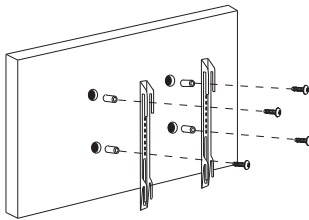

- Remove the four screws that are supplied in the wall mounting holes.
- The wall mount can now be easily attached to the mounting holes on the rear of the TV.
- Install the wall mounting bracket to the television as advised by the bracket manufacturer.

The picture shows the use of spacers, which are not applicable to all sets/installations.

The picture shows the use of spacers, which are not applicable to all sets/installations.

4 First time installation

Basic installation steps are shown below. These may vary slightly depending on model.



Introduction

When the set first turns on, it enters the First Time Installation mode. This can be restarted by restoring the set to default settings in the 'About TV' Menu.

Note: In home mode, the TV will switch off automatically after 4 hours in the event that no buttons are pressed on the TV or remote control. (You can change this by pressing the [MENU] button and then selecting Settings>Time>Auto Standby)



Environment of Use

Home Mode: For normal use, by default it is set to a power saving mode which reduces the energy used by up to 25% (by reducing the power to the LED/LCD panel). This can be changed in the picture mode settings.



Default Source

Select the source which you use the most. If Digital TV (Freeview) is chosen, then at the next step, the set will tune in and default to Digital TV (Freeview). If one of the other sources is selected, then the set will not tune in at this stage and default to that input. If it is required to tune the set in later, press the [MENU] button and then select Settings>Channels



Languages

Select your preferred on-screen display language. This will change the language in which the menus and associated information is displayed in. When set up has been completed, to change this press the [MENU] button and then select Settings > System Menu > Language



Network setup

You can connect the TV to your broadband router or wireless network in order to take advantage of the Smart functions. If you connect the TV to your router using an Ethernet cable (recommended) this step will be skipped.



Tune in Channels

Choose to install terrestrial channels now or later.



Country Selection

Select the correct flag for the country in which the set will be used in. This will enable the set to correctly install the functions applicable in the country of use.



Set Up Netflix

If you have a Netflix account, it can be set up on the television here. Once set up and validated, the First Time Installation returns to the next step.



Support Advice

Information regarding support is displayed for a little while. Tuning continues and a progress bar is shown with the number of channels found indicated below.

If you are picking up signals from more than one transmitter, you will be requested to select your primary and secondary regions.

Connectivity

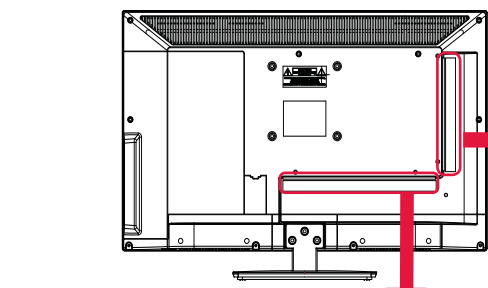

A	ETHERNET*	Network connection	F	HDMI 2	HDMI Input
B	HDMI 1 (ARC)	HDMI input	G	2 x USB	USB Port
C	SCART	SCART Input	H	Earphone	Earphone Input
D	RF in	RF / TV aerial input	I	CI CARD IN	Common Interface module
E	Optical Digital Audio	Digital Audio Output	J	AV IN	Audio/Visual Input
			K	YPbPr	HD input (Ypbpr)

* The Ethernet/LAN port is used for Freeview HD services and smart functions.